

**CERTIFIED LAND CORNER RECORDATION**

DESCRIPTION OF CORNER EVIDENCE FOUND, AND ORIGINAL RECORD (If known)

LOCATION S.35 S.36 S. 2 S. 1 T.14N., R.69W. T.13N., R.69W. 6th P.M.	Found granite stone, 6" x 9" with 1 groove on east and 5 grooves on west. Stone planted and in good condition. G.L.O. record - Granite Boulder, 17 x 10 x 5, 1870.
--	--

DESCRIPTION OF MONUMENT AND ACCESSORIES ESTABLISHED TO PERPETUATE THE ORIGINAL LOCATION OF THIS CORNER:

None

SKETCH, WITH COURSE AND DISTANCE TO ADJACENT CORNER IF DETERMINED IN THIS SURVEY.  
(May Sketch or Paste Reproduction on Reverse Side.)

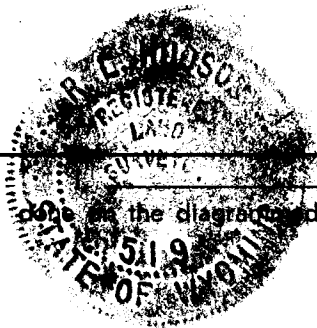
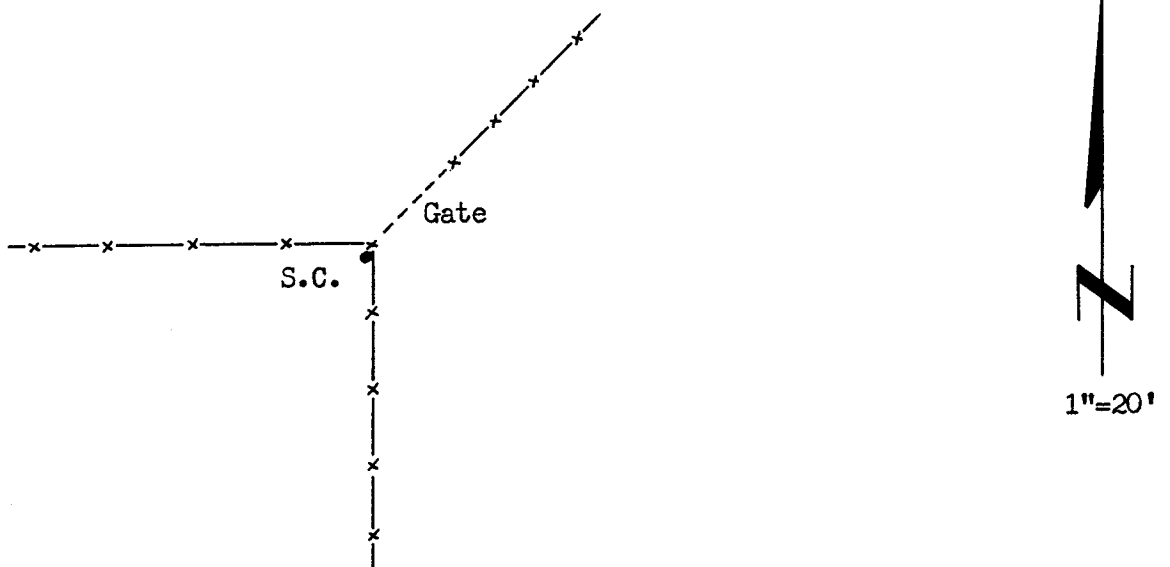

R.L. Hudson

certify that I have carefully performed or reviewed the work done on the diagrammed corner as reported on this recordation form and approve the same.

R.L. Hudson  
Signature of Surveyor

Wyoming L.S. No. 519  
Registration No.

STATE OF WYOMING,

Office of Clerk and Recorder,

County of Laramie

This "corner record" was filed for record on the 13th day of September, 1972, was noted on the cross-index plat and is assigned page No. 14-69, in book No. ONE

Jody B. Hillman  
County Official

Cross Index No. <u>13</u>	T. <u>69</u>	R. <u>6</u>	Mer.
_____	T. _____	R. _____	Mer.
_____	T. _____	R. _____	Mer.
_____	T. _____	R. _____	Mer.
_____	T. _____	R. _____	Mer.
_____	T. _____	R. _____	Mer.
_____	T. _____	R. _____	Mer.

Photographed.....  
Indexed.....X  
Posted.....X

The State of Wyoming }  
County of Laramie } SS

This instrument was filed for record  
at 1:58 o'clock P. M. on the  
6th day of Sept. 1922  
A. D. 19 22 and duly recorded in  
Book ..... on page .....

*John B. Williams*

County Clerk & Ex-Officio Register of Deeds  
By..... Deputy